



Genii™ Flat and Convex
Silicone Ostomy Seals

genius for
preventing
leaks

trio ostomy care™





the first silicone ostomy seal that provides a perfect fit

Genii™ Silicone Ostomy Seals are available in flat and convex to suit all stoma types.



Snug, customized fit

Hugs the stoma, eliminating gaps and leaks



Comfortable and secure

Responds to body movement



Quick and easy to apply

Simply stretch around the stoma without warming or shaping



Protects delicate skin around your stoma

Protection from stool and urine, allowing skin to heal naturally and remain healthy



Longer wear time

Unique Sil2 Breathable Silicone Technology® doesn't absorb bodily fluids so it won't become gooey, mushy, or break down



Also available! Genii™ Convex Ostomy Seals

Ideal for flat or inverted stomas or uneven skin

why is **Sil2** Breathable Silicone Technology® great for skin?

Sil2 Breathable Silicone Technology® is a unique silicone adhesive blend that feels and breathes just like normal skin. It sticks exceptionally well but doesn't absorb moisture. So it won't swell, become mushy, create a goopy mess, or cause pain when you remove it - which means you can wear it for longer without worrying about leaks.



how to use:

1. Clean the area around the stoma. It's important to make sure the skin is dry, as **the seal won't stick to wet skin.**
2. Using your thumb and forefinger, carefully pull the seal from its pack. It's normal for the seal to be fixed to the blister pack, but it's strong enough for you to pull and stretch it free without damage.
3. Take the edge of the seal in both hands and stretch it around the stoma. You can then allow the seal to retract around the stoma to form a comfortable seal.
4. The ostomy seal stretches to fit around the stoma. So there's no need to mold it into shape. Its gentle elasticity will hug the stoma to form the seal.
5. Once it has sealed around the stoma, gently press the seal onto your skin. Place the ostomy pouch directly onto the seal as usual, and hold it in place until it feels secure.

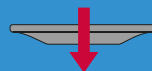
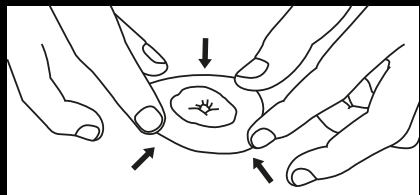
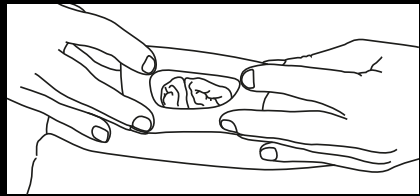
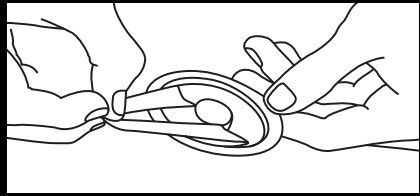

CONVEX

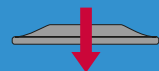

CONCAVE

Convex seals are versatile and can be applied in two ways, either convex side up or convex side down, so that gentle pressure can be applied directly around your stoma to create a secure fit, whichever works best for you.



Genii™ Silicone Ostomy Seals

Our flat and convex seals are part of a complete range of Trio® solutions. Your stoma may change shape and size but our seals will flex and move with your stoma. Find the best one for you by selecting your stoma size and choosing small, medium or large.

Genii™ Flat Ostomy Seals

Item number	Size	Stoma size	Qty/box	HCPCS
TR1020-10	Small	20-35mm (3/4" - 1 1/4")	10	A4385
TR1028-10	Medium	35-50mm (1 1/4" - 2 1/4")	10	A4385
TR1035-10	Large	50-80mm (2 1/4" - 3 1/4")	10	A4385

Genii™ Convex Ostomy Seals

Item number	Size	Stoma size	Qty/box	HCPCS
TR1020CX	Small	20-35mm (3/4" - 1 1/4")	10	A4411
TR1030CX	Large	35-50mm (1 1/4" - 2")	10	A4411

Sillex® Silicone Ostomy Flange Extenders

Item number	Size	Stoma size	Qty/box	HCPCS
TR1060	—	All	20	A4362



Need extra security?

You may have a hernia, do a lot of physical activity, or want peace of mind at night. Our **Flange Extenders** are designed to go around the flange to provide a soft, flexible, invisible border which conforms to your body shape to provide extra security. Get in touch today if you would like more information, or to order your free sample.



TrioOstomyCare.com

877-694-3644

mygenii@TrioOstomyCare.com