

- 01** Take the pack containing the **Siltac**® seal from the dispenser carton, then peel and dispose of the lid from the clear plastic blister.

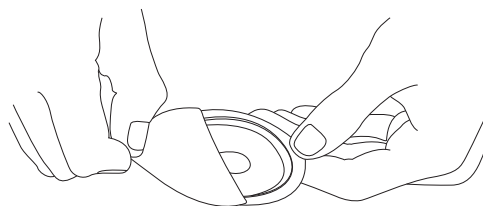

- 02** Grip the blister's peel tab with one hand, and using the thumb of your other hand, gently rub the edge of the **Siltac**® seal away towards the centre of the blister.

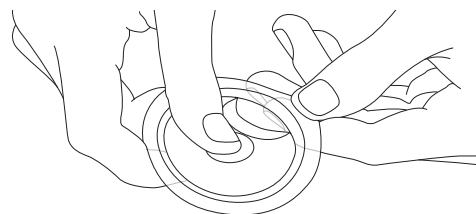

- 03** Then using the thumb and forefinger, carefully pull the seal from its pack. It is normal for the seal to be adhered to the blister pack, but it has been designed to be strong enough to be pulled free from the blister without tearing or damage.

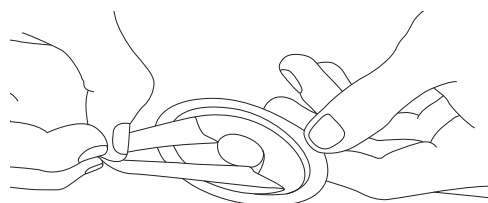

- 04** Before applying the seal, it is very important to ensure your skin is dry. The seal will not stick to wet skin. Taking the edge of the seal in both hands, stretch it around your stoma. You will find that **Siltac**® stretches smoothly and easily and is very tacky in order to form a secure seal around your stoma.

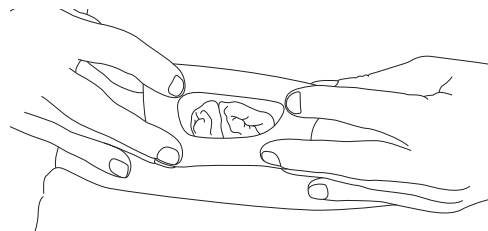

- 05** Then allow **Siltac**® to retract around your stoma to form a comfortable seal. **Siltac**® has been designed to conform and seal around any shape of stoma, so there is no need to mould it to shape; its gentle elasticity will form the seal by itself.

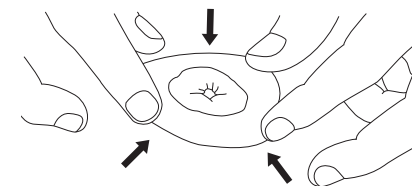

- 06** Once **Siltac**® has sealed around your stoma, gently press it onto the peristomal skin surface. Now place your ostomy pouching system directly onto the surface of the seal as normal, and hold it in place until secure.

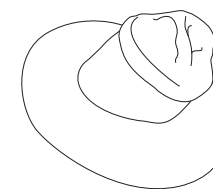

**PLEASE NOTE:-** **Siltac**® is available in three sizes and care should be taken to select the correct size that will retract sufficiently to form a perfect seal around your stoma.

When removing your pouching system **Siltac**® will normally just peel off with the wafer, or if not, it can easily be peeled from the skin in one piece leaving no residue.

- 01** Take the pack containing the **Silvex®** seal from the dispenser carton, then peel and dispose of the lid from the clear plastic blister.

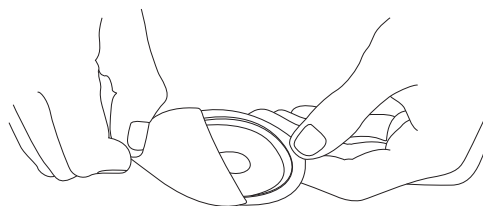

- 02** Grip the blister's peel tab with one hand, and using the thumb of your other hand, gently rub the edge of the **Silvex®** seal away towards the centre of the blister.

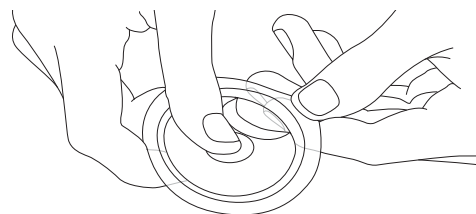

- 03** Then using the thumb and forefinger, carefully pull the seal from its pack. It is normal for the seal to be adhered to the blister pack, but it has been designed to be strong enough to be pulled free from the blister without tearing or damage.

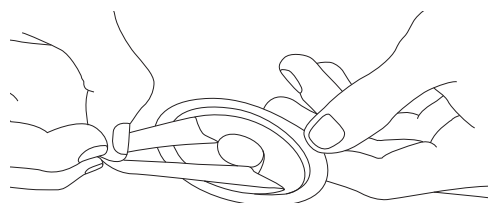

- 04** Before applying the seal, it is very important to ensure your skin is dry. The seal will not stick to wet skin. Taking the edge of the seal in both hands, stretch it around your stoma. You will find that **Silvex®** stretches smoothly and easily and is very tacky in order to form a secure seal around your stoma.

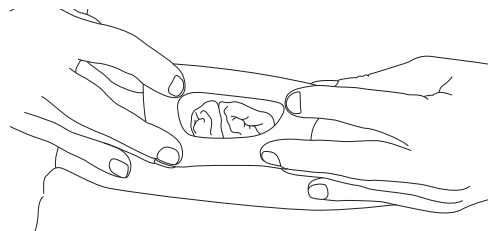

- 05** Then allow **Silvex®** to retract around your stoma to form a comfortable seal. **Silvex®** has been designed to conform and seal around any shape of stoma, so there is no need to mould it to shape; its gentle elasticity will form the seal by itself.

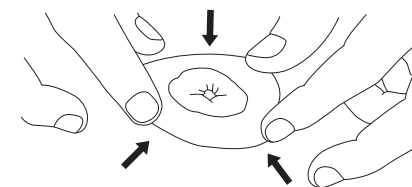

- 06** Once **Silvex®** has sealed around your stoma, gently press it onto the peristomal skin surface. Now place your ostomy pouching system directly onto the surface of the seal as normal, and hold it in place until secure.

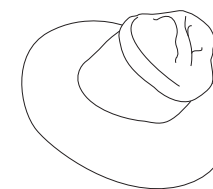

**PLEASE NOTE:-** Silvex® is available in two sizes and care should be taken to select the correct size that will retract sufficiently to form a perfect seal around your stoma.

When removing your pouching system **Silvex®** will normally just peel off with the wafer, or if not, it can easily be peeled from the skin in one piece leaving no residue.